

# 微差压变送器安装指导

## Differential Pressure Transmitter Installation Guide



### 安装指导 / Installation Guide

#### 1. 安装位置 Installation Location

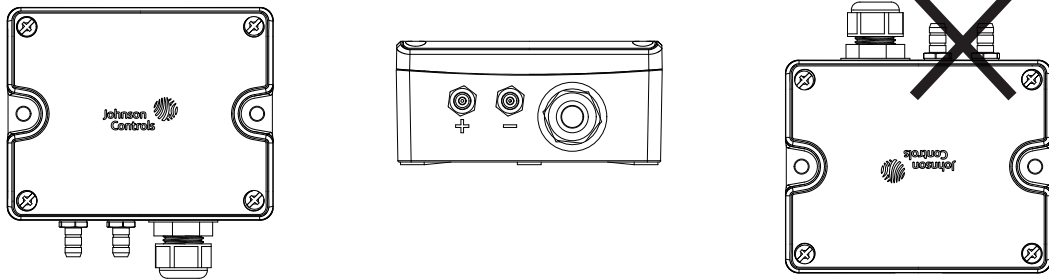

#### 2. 应用 Application

滤网 Filter

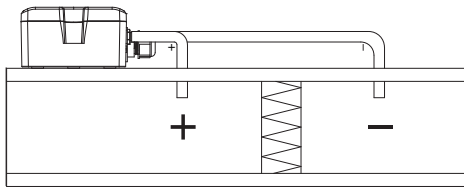

风机 Fan

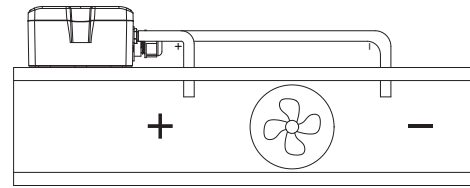

静压 Static Pressure

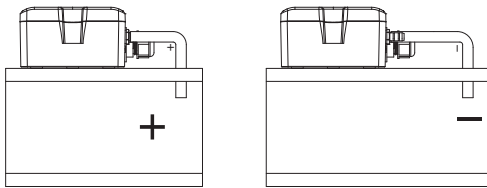

#### 3. 安装尺寸图 Installation Dimension(mm)

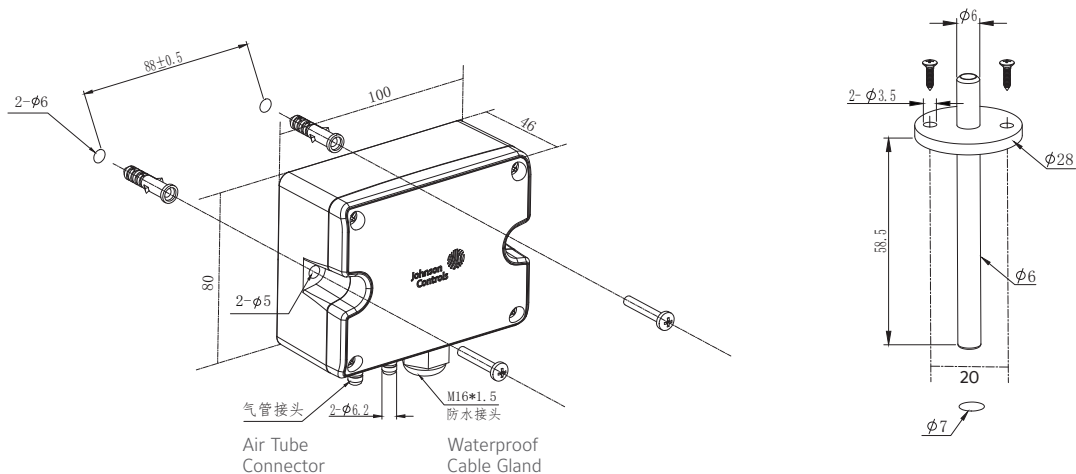



# 设置 /Setting

## 1. 内部功能介绍 Internal function introduction



短按手动清零按钮即可进行清零。（请在正负进气口无差压状态下进行）

Note: Push the manual button for zero operation. (Please ensure no differential pressure between the two air inlet when process)

## 2. 参数设置 Parameter Setting

### 量程设置 Measurement range setting

| 量程拨码<br>开关组合 |                            | Pa      | mmH <sub>2</sub> O | mbar | inH <sub>2</sub> O | mmHG  | kPa    |
|--------------|----------------------------|---------|--------------------|------|--------------------|-------|--------|
|              | DPT7000G100<br>DPT7000C100 | 10      | 1                  | 0.1  | /                  | /     | /      |
|              | DPT7000G200<br>DPT7000C200 | 100     | 10                 | 1    | 0.4                | 0.75  | 0.1    |
|              | DPT7000G300<br>DPT7000C300 | 1,000   | 100                | 10   | 4                  | 7.5   | 1      |
|              | DPT7000G100<br>DPT7000C100 | 25      | 2.0                | 0.25 | /                  | /     | /      |
|              | DPT7000G200<br>DPT7000C200 | 250     | 25                 | 2.5  | 1                  | 1.87  | 0.25   |
|              | DPT7000G300<br>DPT7000C300 | 2,500   | 250                | 25   | 10                 | 18.75 | 2.5    |
|              | DPT7000G100<br>DPT7000C100 | 50      | 5                  | 0.5  | /                  | /     | /      |
|              | DPT7000G200<br>DPT7000C200 | 500     | 50                 | 5    | 2                  | 3.75  | 0.5    |
|              | DPT7000G300<br>DPT7000C300 | 5,000   | 500                | 50   | 20                 | 37.5  | 5      |
|              | DPT7000G100<br>DPT7000C100 | 75      | 7.5                | 0.75 | /                  | /     | /      |
|              | DPT7000G200<br>DPT7000C200 | 750     | 75                 | 7.5  | 3                  | 5.62  | 0.75   |
|              | DPT7000G300<br>DPT7000C300 | 7,500   | 750                | 75   | 30                 | 56.2  | 7.5    |
|              | DPT7000G100<br>DPT7000C100 | 100     | 10                 | 1    | /                  | /     | /      |
|              | DPT7000G200<br>DPT7000C200 | 1,000   | 100                | 10   | 4                  | 7.5   | 1.000  |
|              | DPT7000G300<br>DPT7000C300 | 10,000  | 1,000              | 100  | 40                 | 75    | 10     |
|              | DPT7000G100<br>DPT7000C100 | ±100    | ±10                | ±1   | /                  | /     | /      |
|              | DPT7000G200<br>DPT7000C200 | ±1,000  | ±100               | ±10  | ±4                 | ±7.5  | ±1.000 |
|              | DPT7000G300<br>DPT7000C300 | ±10,000 | ±1,000             | ±100 | ±40                | ±75   | ±10    |

其中 1 号开关设置请参考如下  
(for switch 1 please refer to below setting):



图 1: 正向测量  
Figure1: Positive measurement range



图 2: 双向测量，即零点在中间  
Figure2: Bidirectional measurement range, means zero in the middle of range

举例：以第一个型号 0~10Pa 为例，若将 1 号开关如图 1 设置即量程范围为 0~10Pa，若设置为图 2，则量程范围为 -5~5Pa。

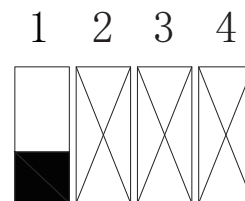
For example, the first item(0~10Pa) in the table, if set the switch 1 as the figure1, its measurement range is 0~10Pa, if set as the figure2, its measurement range is -5~5Pa.

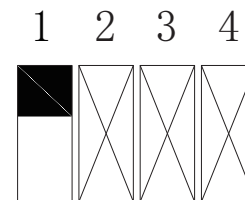

## 设置 / Setting

### 单位设置与自动清零设置 Unit Setting and Auto Calibration Setting

|                        |                    |                    |      |                    |      |     |
|------------------------|--------------------|--------------------|------|--------------------|------|-----|
| 单位<br>Unit             | Pa<br>(默认/Default) | mmH <sub>2</sub> O | mbar | inH <sub>2</sub> O | mmHG | kPa |
| 开关<br>位置<br>DIP Switch |                    |                    |      |                    |      |     |

其中 1 号开关代表自动清零按钮  
(Switch 1 means button of auto zero calibration)



### 响应时间设置 Response time Setting

|                              |                      |    |    |    |
|------------------------------|----------------------|----|----|----|
| 时间<br>Time                   | 0.5s<br>(默认/Default) | 1s | 2s | 4s |
| 接指<br>开关<br>位置<br>DIP Switch |                      |    |    |    |



## 接线 / Wiring

### 通用型 General type

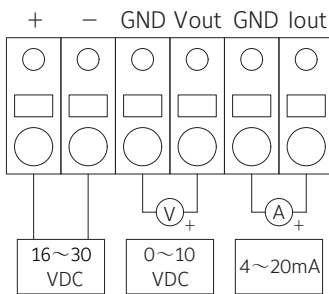

### 电流型 Current type

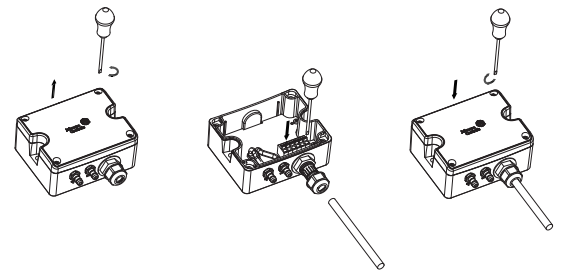
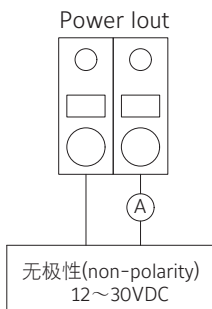

## 基本参数 / Specification

|                             |   |
|-----------------------------|---|
| 测量介质<br>Measure medium      | 空气或中性气体<br>Air and neutral gas  |
| 过载压力<br>Overload pressure   | 5KPa (-100~100Pa)<br>10KPa (-1000~1000Pa)<br>80KPa (-10000~10000Pa)                       |
| 电源供电<br>Power               | 12-30VDC (电流型 / Current type)<br>16-30VDC (通用型 / General type)                            |
| 工作温度<br>Working temperature | -10~60 °C   |
| 安装附件<br>Accessory           | 包含: 1.5m PVC 软管一根, 导压管 2 个, 安装螺钉<br>Includes: 1.5m PVC, 2 pressure tubes, mounting screws |





## 常见问题及解决方法 Problems and Solutions

### 1、量程或单位与设置不符

Measurement range or unit not the same with setting

a) 拨码开关未拨到位，下电重拨后重新启动。

Check the setting of DIP switch, offsite and restart

### 2、加压后输出值无变化或变化不准

No output change or inaccuracy when measurement range change

a) 检查接线连接是否正常；

Check the wiring as correct setting

b) 加载压力是否超过爆破压力直接冲坏压力芯体；

Check if high pressure broken the inner sensor

c) 使用介质是否存在腐蚀性或者与所购产品适用介质存在出入（现有微压差变送器均为无腐蚀性气体）；

Check the measurement medium to ensure if compatible with requirement, should no noncorrosive gas

d) 检查进气软管有无异物阻塞（颗粒物或者水柱）或泄漏；

Check whether the air tube is blocked by foreign matter (particulate matter or water column) or leaking;

e) 使用环境温度是否超出补偿温度范围（微压差变送器温度补偿范围 -10~60℃）；

Whether the ambient temperature exceeds the compensation temperature range (compensation temperature range is -10~60℃);

f) 有无在加压情况下进行清零误操作，如有则在确定无输入压力状态下再次清零；

Zero calibration should be operated under no pressure impact, if any impact, please try again when removed

g) 有无对设置按钮进行误操作（设置按钮有防误操作机制，即设置点压力值必须从小往大递增才能最后设置成功，需在高精压力源下进行校准设置，不推荐客户自行校准，如因校准操作造成偏差，则需返厂重校）。

Is there any mis-operation of the setting button (the setting button has an anti-misoperation mechanism, the pressure value of the setting point must increase from small to large to finally set successfully, and the calibration setting should be carried out under high precision pressure source. It is not recommended for customers to calibrate by themselves. If there is any deviation caused by the calibration operation, they need to return to the factory for re-calibration).

### 3、零点压力值有轻微漂移

Slight drift of zero pressure

a) 待漂移稳定后进行清零操作。

Push button to manual zero calibration after the drift is stabilized.



## 有害物质声明表 Component and content of harmful substances

| 部件名称<br>Component | 有害物质 harmful substances |           |           |                 |               |                 |
|-------------------|-------------------------|-----------|-----------|-----------------|---------------|-----------------|
|                   | 铅<br>(Pb)               | 汞<br>(Hg) | 镉<br>(Cd) | 六价铬<br>(Cr(VI)) | 多溴联苯<br>(PBB) | 多溴二苯醚<br>(PBDE) |
| 外壳<br>Cover       | O                       | O         | O         | O               | O             | O               |
| 探头<br>Probe       | O                       | O         | O         | O               | O             | O               |
| PCBA              | O                       | O         | O         | O               | O             | O               |
| 电气插座<br>Terminal  | X                       | O         | O         | O               | O             | O               |

本表格依据 SJ/T11364 的规定编制

This form is prepared in accordance with SJ/T11364

O: 表示该有害物质在该部件所有均质材料中的含量均在 GB/T26572 规定的限量要求以下

O: Indicates that the content of the hazardous substance in all homogeneous materials of the component is below the limit requirement specified in GB/T26572

X: 表示该有害物质至少在该部件的某一均质材料中的含量超出 GB/T26572 规定的限量要求

X: Indicates that the hazardous substance contained in at least one of the homogeneous materials of the component exceeds the limit requirements specified in GB/T26572

未列入表内的其他部件，皆不含任何超出限量要求的限制使用物质

All other components not listed in this table, do not contain restricted substances above the threshold level.

